

ANIL VALAVALKAR & ASSOCIATES

ARCHITECTS AND INTERIOR DESIGNERS

21/B DHAWALGIRI, SONAWALA ROAD, GOREGAON (E).

MUMBAI - 400063, PH:2668 4839

TO WHOM SOEVER IT MAY CONCERN

Date: 13/04/2017

This is to certify that land used for B.Sc. Nursing Course Ideal Institute of Nursing, Gut No. 40 (Hissa No.1& 2), Pimplaj road, Village Poshari, Tal - Wada, Dist - Palghar, Maharashtra- 421303 is One piece of Land and instructional area is available in the college :-

S.No.	Room Type	Area (Sq.ft)	Completion of Flooring
1	Principal Room	300	Ready
2	Nutrition Lab	900	Ready
3	Paediatric Lab	900	Ready
4	Lecture Hall 1	1080	Ready
5	Lecture Hall 2	1080	Ready
6	Lecture Hall 3	1080	Ready
7	Lecture Hall 4	1080	Ready
8	Faculty Room	2400	Ready
9	Boys Common Room	1000	Ready
10	A.V AID Room	700	Ready
11	Pre Clinical Lab	900	Ready
12	Community Lab	900	Ready
13	Seminar hall	2000	Ready
14	Foundation Lab	1500	Ready
15	Library	2400	Ready
16	Multi Purpose Hall	3000	Ready
17	Girls Common Room	1000	Ready
18	Staff Room	900	Ready
19	Girls Wash Room	500	Ready
20	Boys Wash Room	500	Ready
TOTAL AREA		24120	

For Anil Valavalkar & Co.

For Anil Valavalkar & Associates

Anil Valavalkar
Proprietor





LOCATION PLAN

SCALE 1:1000

Out No 93

Area	Area (sq. m)	Area (sq. ft)
1		
2		
3		
4		
5		
6		
7		
8		
9		
10		
11		
12		
13		
14		
15		
16		
17		
18		
19		
20		
21		
22		
23		
24		
25		
26		
27		
28		
29		
30		
31		
32		
33		
34		
35		
36		
37		
38		
39		
40		
41		
42		
43		
44		
45		
46		
47		
48		
49		
50		

Area	Area (sq. m)	Area (sq. ft)
1		
2		
3		
4		
5		
6		
7		
8		
9		
10		
11		
12		
13		
14		
15		
16		
17		
18		
19		
20		
21		
22		
23		
24		
25		
26		
27		
28		
29		
30		
31		
32		
33		
34		
35		
36		
37		
38		
39		
40		
41		
42		
43		
44		
45		
46		
47		
48		
49		
50		

P. G. Area

107 PSHEN/28 ATPS, WIDE ROAD

12 Mtrs. wide APPROACH ROAD

107 PSHEN/28

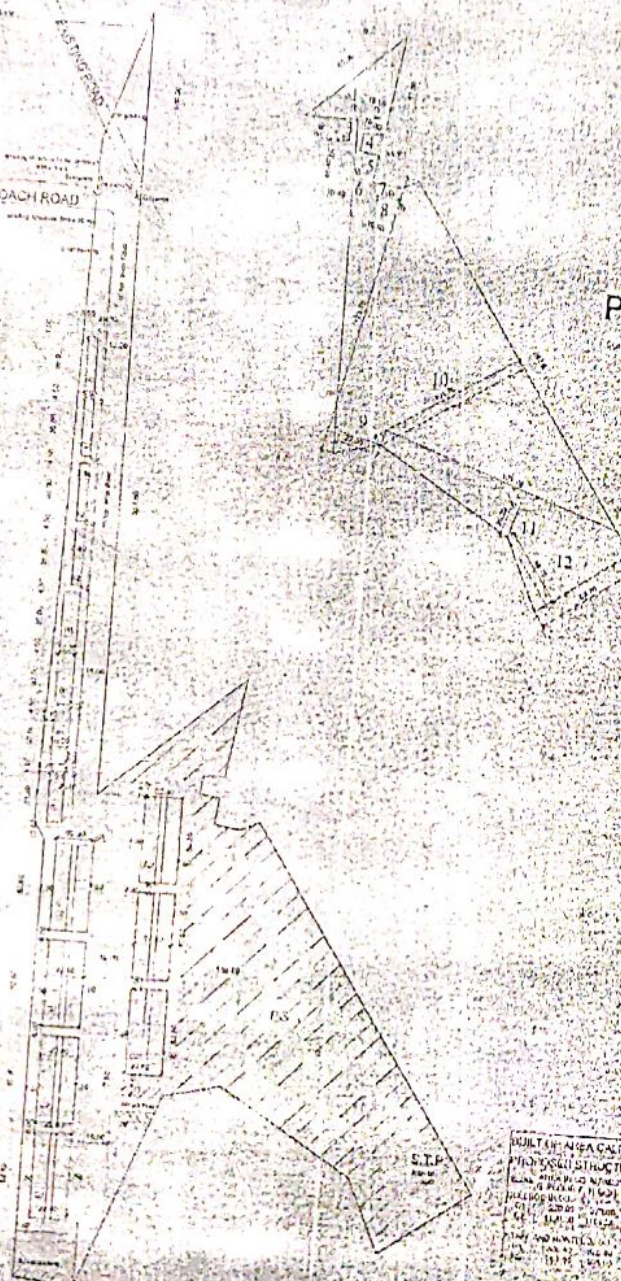

Area	Area (sq. m)	Area (sq. ft)
1		
2		
3		
4		
5		
6		
7		
8		
9		
10		
11		
12		
13		
14		
15		
16		
17		
18		
19		
20		
21		
22		
23		
24		
25		
26		
27		
28		
29		
30		
31		
32		
33		
34		
35		
36		
37		
38		
39		
40		
41		
42		
43		
44		
45		
46		
47		
48		
49		
50		

CHARACTER OF PROJECT

DESCRIPTION OF PROJECT

Area	Area (sq. m)	Area (sq. ft)
1		
2		
3		
4		
5		
6		
7		
8		
9		
10		
11		
12		
13		
14		
15		
16		
17		
18		
19		
20		
21		
22		
23		
24		
25		
26		
27		
28		
29		
30		
31		
32		
33		
34		
35		
36		
37		
38		
39		
40		
41		
42		
43		
44		
45		
46		
47		
48		
49		
50		

Area	Area (sq. m)	Area (sq. ft)
1		
2		
3		
4		
5		
6		
7		
8		
9		
10		
11		
12		
13		
14		
15		
16		
17		
18		
19		
20		
21		
22		
23		
24		
25		
26		
27		
28		
29		
30		
31		
32		
33		
34		
35		
36		
37		
38		
39		
40		
41		
42		
43		
44		
45		
46		
47		
48		
49		
50		

SITE PLAN



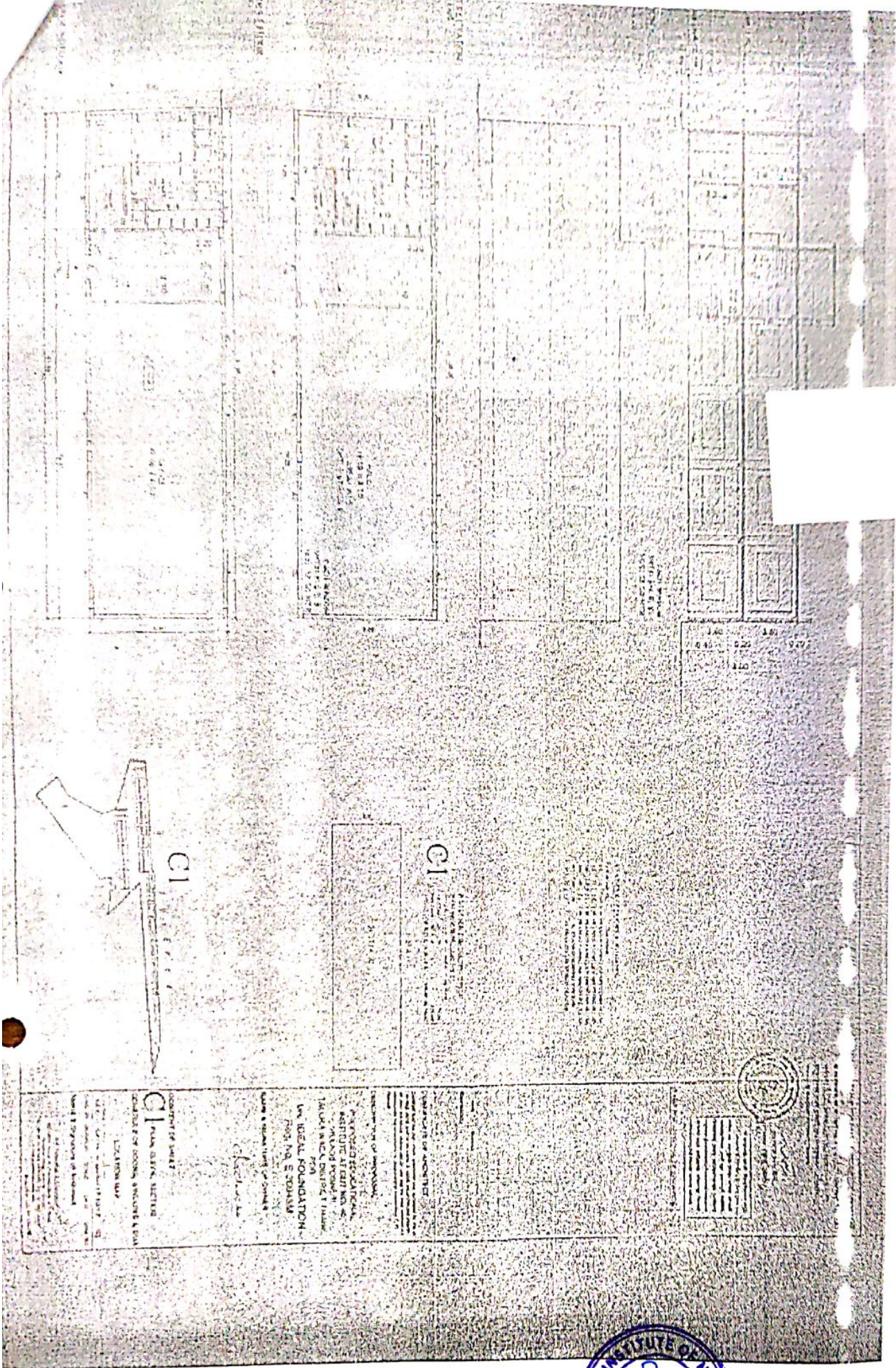

C1

C1

C1 **COMPONENT OF UNIT 1**
CONSTITUTE OF DOING, SECURE & FOR
 LOCATION MAP
 1. The site is situated at the corner of the road and the road is shown in the plan.
 2. The site is shown in the plan.
 3. The site is shown in the plan.

C1 **PLAN, SECTION, SECTION**
 1. The site is situated at the corner of the road and the road is shown in the plan.
 2. The site is shown in the plan.
 3. The site is shown in the plan.

C1 **PLAN, SECTION, SECTION**
 1. The site is situated at the corner of the road and the road is shown in the plan.
 2. The site is shown in the plan.
 3. The site is shown in the plan.

C1 **PLAN, SECTION, SECTION**
 1. The site is situated at the corner of the road and the road is shown in the plan.
 2. The site is shown in the plan.
 3. The site is shown in the plan.

